

CFM-HB240

The CFM-HB240 product line is custom designed to match the airflow needs of big size engine power train with reduced available space.

The system is optimized for power density, package and efficiency.

It is extensively tested for the severe engine bay working condition and its reliability is proved by millions of applications world-wide.

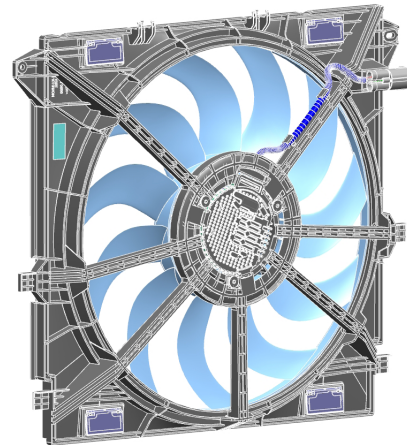

Technology Leadership

- Highest power density
- Compact and slim design
- Low weight for fuel economy and reduced emissions
- Low noise and vibration

Performance Range

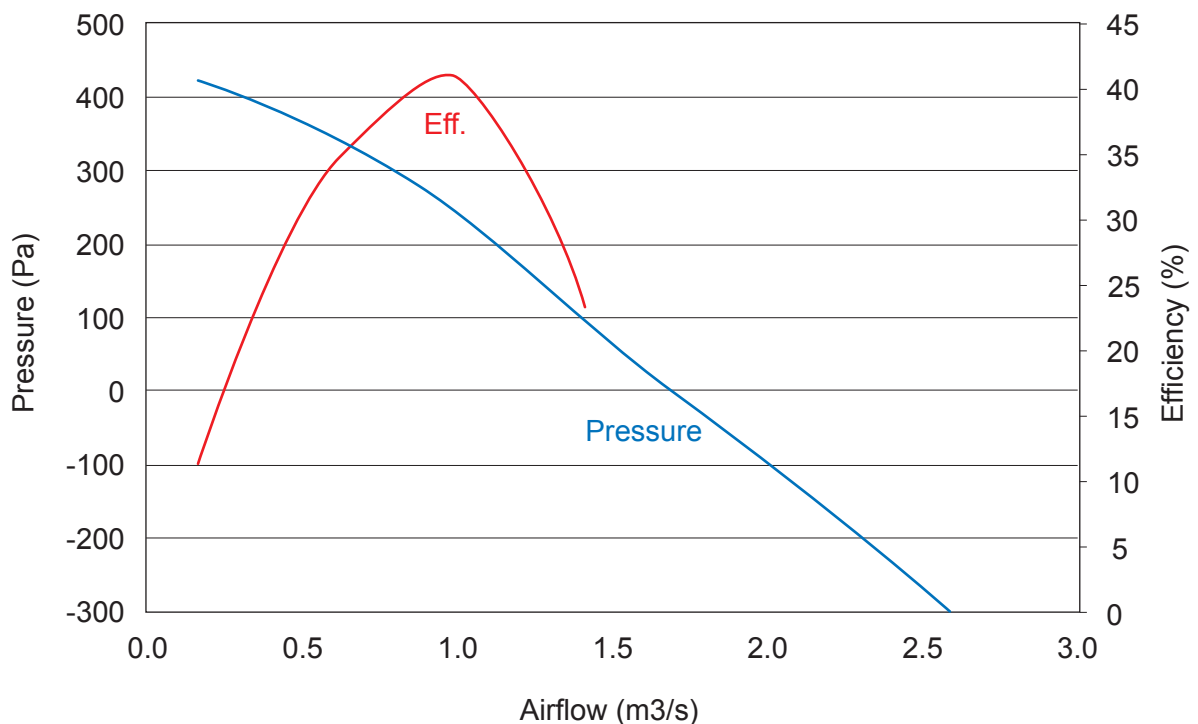

CFM-HB240

Specification

■ Airflow power	: 240 W (*)
■ Motor and Fan length	: 69 mm (*)
■ Weight	: 3.95 Kg (*)
■ Efficiency	: up to 42 % @ 90°C (*)
■ Fan Diameter	: up 590 mm
■ Supply	: 9 to 16 V
■ Temperature	: - 40°C to + 110°C (peak 125°C) (*)
■ Absorbed power	: below 600W
■ Life	: 3,000 hours (**)
■ EMC	: according to CISPR 25
■ Compliance	: ELV 2000/53/CE

(*)

GATE cooling fans are designed to meet customer requirements on airflow power, axial length, weight and efficiency.

Performance range and max efficiency are designed to meet radiator characteristics

Ref.: 500x600mm, PA6-GF30

Extended post heating temperature available

(**) Life depends on customer mission profile. Extended life up to 30.000h for PHEV vehicles

Customized to your needs

- Fan is designed to meet the maximum efficiency and minimum noise
- Shroud can interface with any vehicle radiators and auxiliary components
- Motor is customized from a wide portfolio of brushless motor
- Integrated connector and flying leads
- Speed flaps
- Protection and diagnostics:
 - PWM or LIN input command
 - Partial and full stall protection
 - Over-temperature
 - Over/Under-voltage
 - Over-current
 - MOS Vds protection

CFM-HB340

The CFM-HB340 product line is custom designed to match the airflow needs of big size engine power train with reduced available space.

The system is optimized for power density, package and efficiency.

It is extensively tested for the severe engine bay working condition and its reliability is proved by millions of applications world-wide.

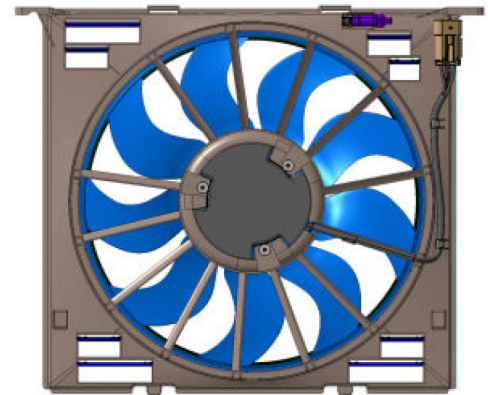

Technology Leadership

- Highest power density
- Compact and slim design
- Low weight for fuel economy and reduced emissions
- Low noise and vibration

Performance Range

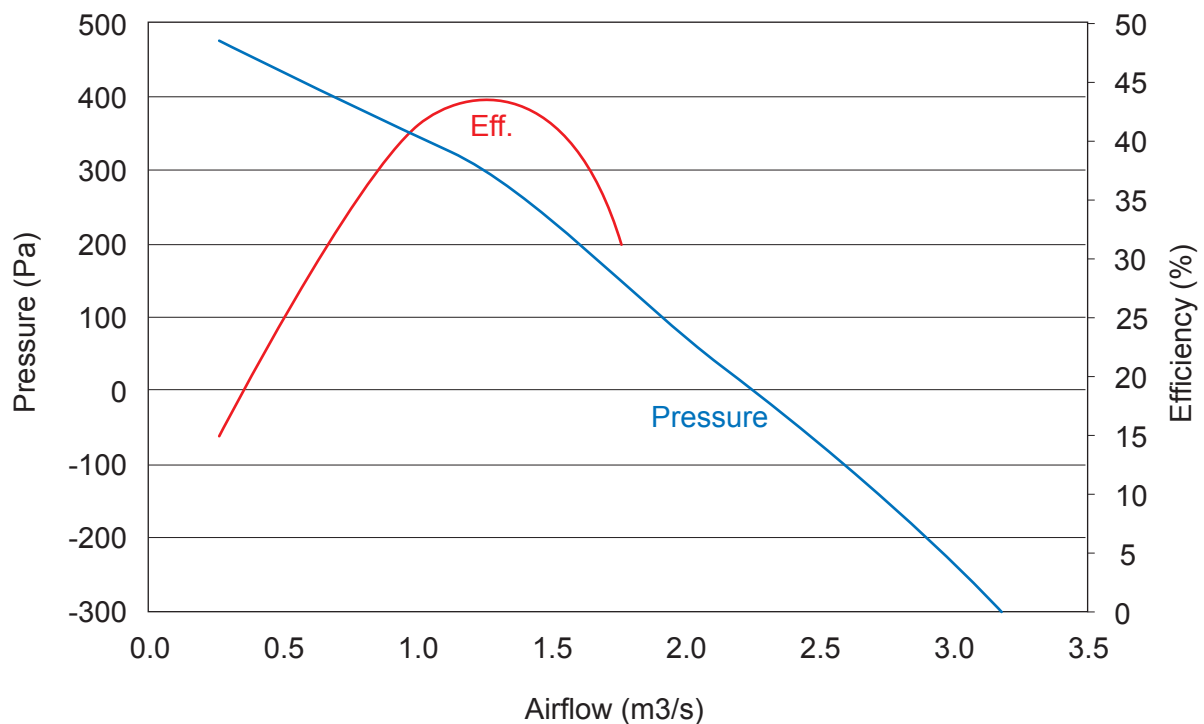

CFM-HB340

Specification

■ Airflow power	: 340 W (*)
■ Motor and Fan length	: 71 mm (*)
■ Weight	: 4.25 Kg (*)
■ Efficiency	: up to 42 % @ 90°C (*)
■ Fan Diameter	: up 590 mm
■ Supply	: 9 to 16 V
■ Temperature	: - 40°C to + 110°C (peak 125°C) (*)
■ Absorbed power	: below 850W
■ Life	: 3,000 hours (**)
■ EMC	: according to CISPR 25
■ Compliance	: ELV 2000/53/CE

(*)

GATE cooling fans are designed to meet customer requirements on airflow power, axial length, weight and efficiency.

Performance range and max efficiency are designed to meet radiator characteristics

Ref.: 500x600mm, PA6-GF30

Extended post heating temperature available

(**) Life depends on customer mission profile. Extended life up to 30.000h for PHEV vehicles

Customized to your needs

- Fan is designed to meet the maximum efficiency and minimum noise
- Shroud can interface with any vehicle radiators and auxiliary components
- Motor is customized from a wide portfolio of brushless motor
- Integrated connector and flying leads
- Speed flaps
- Protection and diagnostics:
 - PWM or LIN input command
 - Partial and full stall protection
 - Over-temperature
 - Over/Under-voltage
 - Over-current
 - MOS Vds protection

CFM-HB400

The CFM-HB400 product line is custom designed to match the airflow needs of big size engine power train with reduced available space.

The system is optimized for power density, package and efficiency.

It is extensively tested for the severe engine bay working condition and its reliability is proved by millions of applications world-wide.

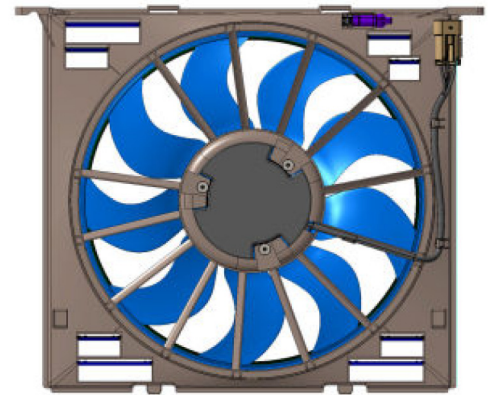

Technology Leadership

- Highest power density
- Compact and slim design
- Low weight for fuel economy and reduced emissions
- Low noise and vibration

Performance Range

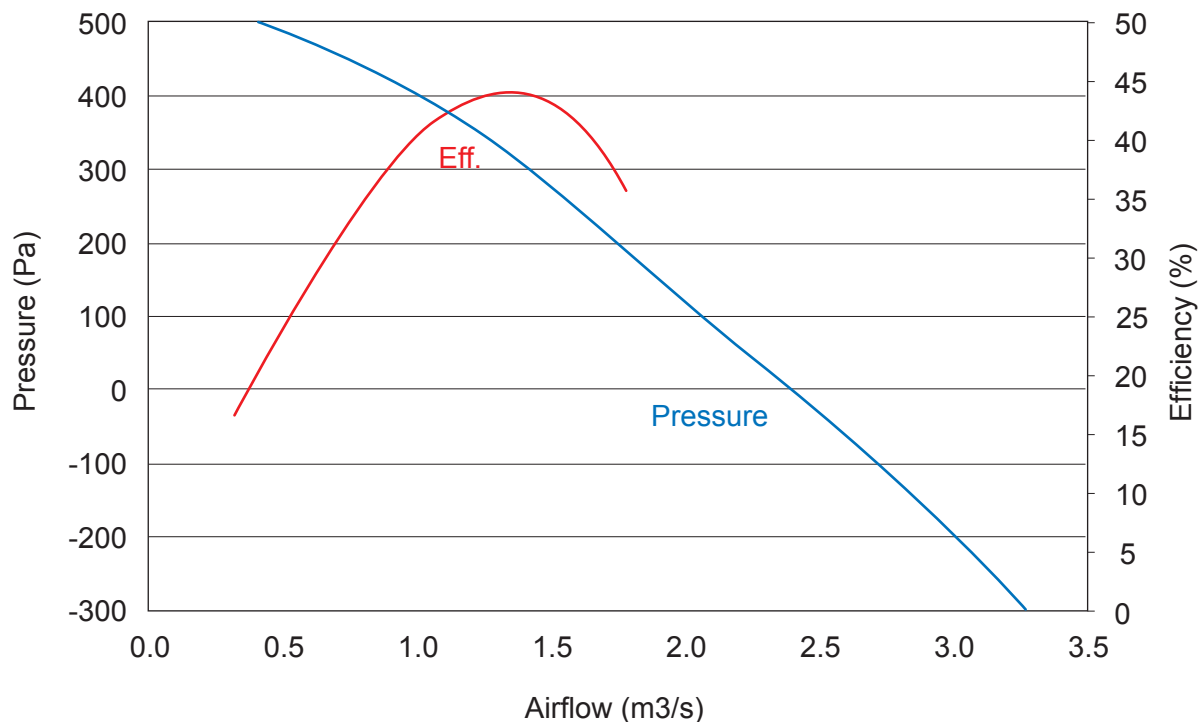

CFM-HB400

Specification

■ Airflow power	: 400 W (*)
■ Motor and Fan length	: 76 mm (*)
■ Motor weight	: 4.6 Kg (*)
■ Efficiency	: up to 42 % @ 90°C (*)
■ Fan Diameter	: up 590 mm
■ Supply	: 9 to 16 V
■ Temperature	: - 40°C to + 110°C (peak 125°C) (*)
■ Absorbed power	: below 1000W
■ Life	: 3,000 hours (**)
■ EMC	: according to CISPR 25
■ Compliance	: ELV 2000/53/CE

(*)

GATE cooling fans are designed to meet customer requirements on airflow power, axial length, weight and efficiency.

Performance range and max efficiency are designed to meet radiator characteristics

Ref.: 500x600mm, PA6-GF30

Extended post heating temperature available

(**) Life depends on customer mission profile. Extended life up to 30.000h for PHEV vehicles

Customized to your needs

- Fan is designed to meet the maximum efficiency and minimum noise
- Shroud can interface with any vehicle radiators and auxiliary components
- Motor is customized from a wide portfolio of brushless motor
- Integrated connector and flying leads
- Speed flaps
- Protection and diagnostics:
 - PWM or LIN input command
 - Partial and full stall protection
 - Over-temperature
 - Over/Under-voltage
 - Over-current
 - MOS Vds protection